

# LINKSYS®

A Division of Cisco Systems, Inc.

## QUICK INSTALLATION

# Wireless-G Internet Home Monitoring Camera

### Package Contents

- Wireless-G Internet Home Monitoring Camera
- Camera Stand/Wall Mount
- Power Adapter
- Ethernet Network Cable
- Start Here Folder
- CD-ROM with Setup Wizard and User Guide
- Quick Installation Guide

Model: **WVC54GCA**



# 1 Installation

- A.** Insert the Setup CD-ROM into your CD-ROM drive.

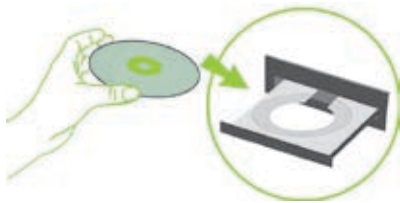

- B.** The Setup Wizard's *Welcome* screen appears. Click **Click Here to Start**.



- C.** On the next screen that appears, click **Setup Camera**.



- D.** On the *End User License Agreement* screen, check the box next to **I accept the agreement** and click **Next** if you agree and want to continue the installation, or click **Exit** to end the installation.



- E.** Connect the included network cable to your network router or switch. Click **Next**.



- F.** Connect the other end of the network cable to the Camera's Ethernet port. Click **Next**.



- G.** Plug the included power adapter into the Camera's Power port. Plug the other end into an electrical outlet. Click **Next**.



- H.** Make sure the LED is lit on the Camera's front panel. If it is not lit, make sure the cables are properly connected to the Camera. Click **Next**.



- I. The Wizard searches for the Wireless-G Internet Home Monitoring Cameras on your network, then displays the Camera found along with status information.

If the Camera you want is not displayed, click **Search Again** to run a new search for Cameras.

Otherwise, in the *Camera List* box, click the name of the Camera you are currently installing. Write down the IP address of the Camera, so you can use it to access the Web-based Utility later. Click **Next**.



- J. Enter a name for the Camera. Memorable names are helpful, especially if you are using multiple Cameras on the same network. It should have 15 characters or fewer. After you have entered the name, click **Next**.



- K. Select how to assign an IP Address to the Camera, either automatically or manually. Then click **Next**.

**Automatically obtain an IP Address** Select this option if you want to automatically assign an IP address to the Camera using DHCP. If you are not sure which option to choose, Linksys recommends this option.



Automatically Assign IP Address Using DHCP



**WPA/WPA2-Personal** Enter a passphrase in the *Passphrase* field and click **Next**. The passphrase is case-sensitive and must be from 8 to 63 characters in length.



WPA/WPA2-Personal

**WEP (64-Bit) or WEP (128-Bit)** To generate the WEP key automatically, enter a passphrase in the *Passphrase* field and click **Next**. The passphrase is case-sensitive and should not be longer than 16 characters. It must match the passphrase of your other wireless network devices and is compatible with Linksys wireless products only. (If you have any non-Linksys wireless products, enter the WEP key manually on those products.)



WEP (64-Bit or 128-Bit)

To manually enter a WEP key, leave the *Passphrase* field blank, click **Next**, and enter the WEP key on the next screen. This WEP key must match the WEP key of your wireless network. For 64-bit WEP encryption, enter exactly 10 hexadecimal characters. For 128-bit WEP encryption, enter exactly 26 hexadecimal characters. Valid hexadecimal characters are "0" to "9" and "A" to "F". After you have entered the WEP key, click **Next**.

- O.** Review the Camera's settings. To make changes to the settings, click **Back** to go back to the previous screen. If the settings are correct, click **Save** to continue.



**P.** When the Wizard informs you that the new Camera settings have been saved, click **Continue**.

**Q.** Disconnect the power from the camera. Click **Next**.



**R.** Disconnect the network cable from the Camera and from your switch or router. Click **Next**.



**S.** Reconnect the power to the Camera. Click **Next**.



- T.** When the Setup Wizard displays **Camera successfully connected to network**, click **Continue**, then click **Next**.



- U.** The *Congratulations* screen appears.



**Congratulations! The installation of the Camera is complete.**



**NOTE:** For information on installing and using the Camera Utility, and for information on the Camera's advanced settings, refer to the User Guide on the CD-ROM.

For additional information or troubleshooting help, refer to the User Guide on the CD-ROM. Additional support is also available by phone or online.

**24-Hour Technical Support**  
800-326-7114

**Website**  
<http://www.linksys.com>

**Support**  
<http://www.linksys.com/support>

**RMA (Return Merchandise Authorization)**  
<http://www.linksys.com/warranty>

**FTP Site**  
<ftp://ftp.linksys.com>

**Sales Information**  
800-546-5797 (800-LINKSYS)



Linksys is a registered trademark or trademark of Cisco Systems, Inc. and/or its affiliates in the U.S. and certain other countries. Copyright © 2007 Cisco Systems, Inc. All rights reserved. Other brands and product names are trademarks or registered trademarks of their respective holders.

**LINKSYS®**  
A Division of Cisco Systems, Inc.

7101210N-AI